

Pushout for Pi 3 HDMI port

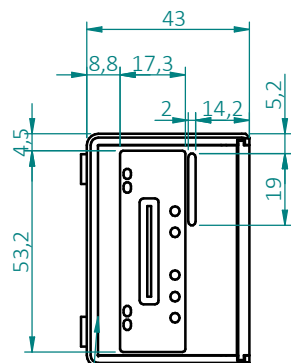

Front panel slot added to accomodate Pi 3 and Pi 4 in the end panel. This would decrease the strength of the panel so could look at bonding this to the base.

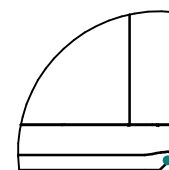
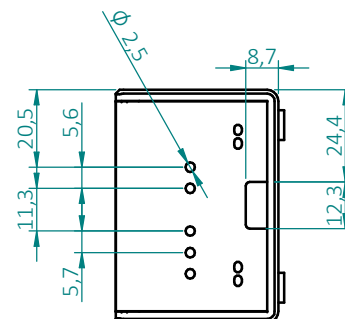
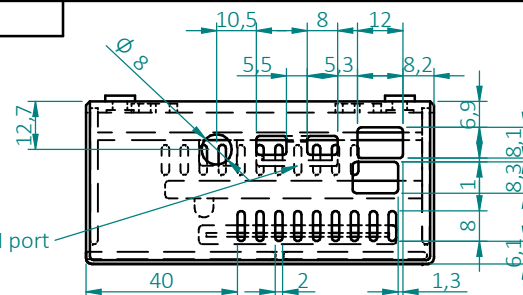
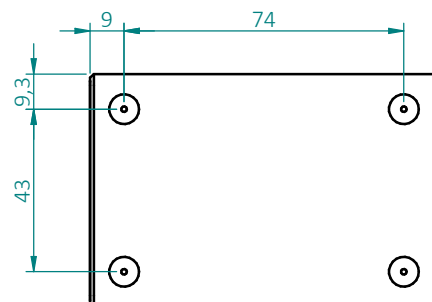
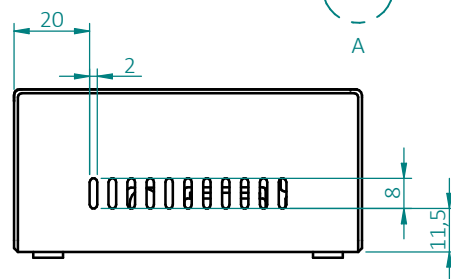
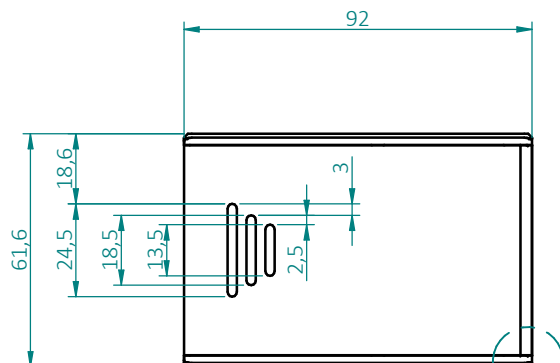

DETAIL A

1.0 x 45° CHAMFER in the place of the 1.5mm Roundover to limit scratching.

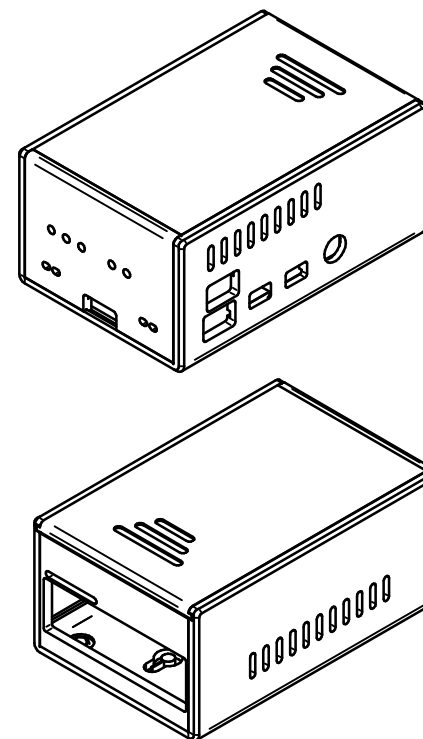

MATERIAL		DRAWN BY	Jack.Seeley	03/02/2020
THICKNESS		CUSTOMER	NEBRA (PI SUPPLY)	
www.smartboxx.co.uk		PART NO.	4520 (GA) -02	
		REV 02	SCALE: 1:1	SHEET 1 OF 1
				A4